

POWERREX KOREA SL3600A/SL3600L Four Post Vehicle Hoist

- SL3600A Alignment Lift
- SL3600L Standard Lift
- Manufactured in Korea
- Supplied with 2 x jacking beams
- Automatic safety lock system
- Cable breakage emergency locking system
- Wide and long to accommodate large vehicles
- Total length 6075mm
- Runway width 575
- 6 button remote control
- Premium quality lift
- Meets Australia/NZ safety regulations and European CE Safety Certified

Manufactured In Korea, the Powerrex SL3600A four post vehicle hoist is a wide body wheel alignment hoist with a 4 tonne lift capacity. The SL3600A includes turntable recesses and rear slip plates for wheel alignment. Jacking bridges are also included, permitting the operator to lift the wheels free of the platform.

RED OR
BLUE
NORMALLY
AVAILABLE

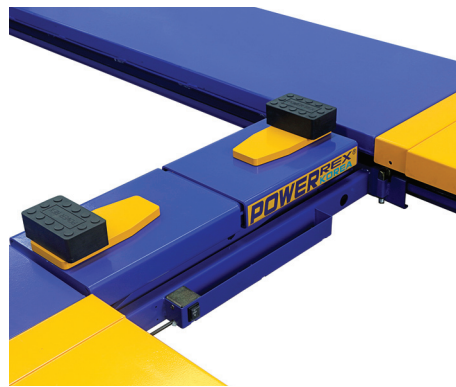

SPECIFICATIONS	
Capacity	4000kg
Lift height	1800mm
Min height	235mm
Lifting time (approx) 3PH	40-50sec
Weight	1800
Power supply	220V or 380v/3ph
Warranty	2 Year

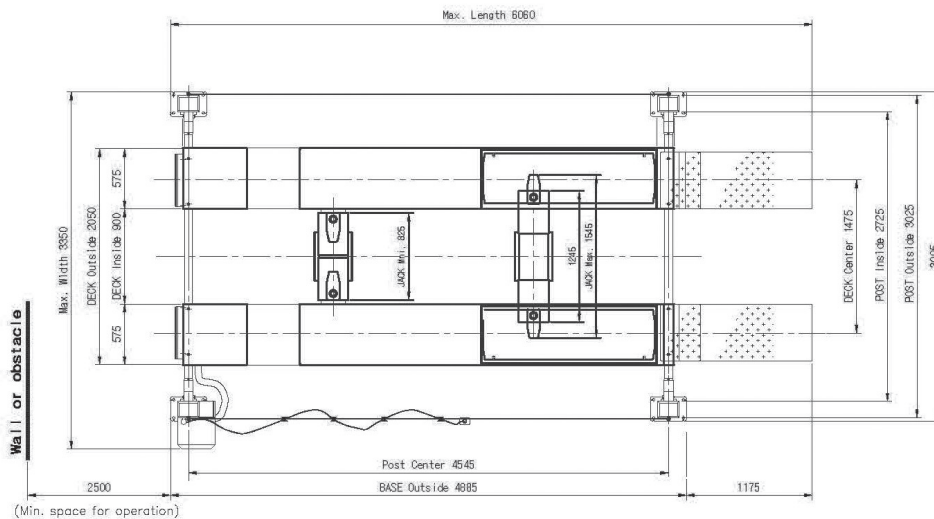

THE CONCRETE MUST:

- Have a minimum thickness of 150mm
- Be reinforced
- Be a grade of no less than 25MPA

